

**vtech**<sup>®</sup>

# Brainy Baby<sup>®</sup>

**User's Manual**

**Baby  
Face<sup>™</sup>**

Age 3 months+

**Right Brain<sup>™</sup>**

Inspires Creative Thinking

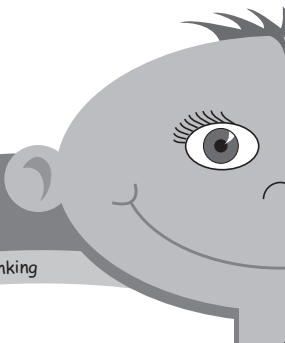

**Dear Parent:**

Ever notice the look on your baby's face when he learns something new? These moments are a parent's greatest reward. To encourage these moments, we have created the Brainy Baby Left Brain™ and Right Brain™ series of toys.

Based on the award-winning Brainy Baby® video series, these toys will help develop both sides of a child's brain to give him a cognitive advantage. Right Brain™ toys focus on encouraging creative skills such as music, art, imagination, and creative thinking. Left Brain™ toys are designed to encourage cognitive thinking skills such as logic, patterns, letters & numbers, and analyzing details. Working together, this revolutionary line of toys will engage your child's whole brain, and boost a baby's intellect!

At Brainy Baby®, we know that your child's education begins at birth - and we're proud to be a part of that. After all, at VTech® and Brainy Baby®, your child's future is our inspiration!

Sincerely,

Your Friends at VTech® and The Brainy Baby® Company

To learn more about these and other Brainy Baby® products, please visit [www.brainybaby.com](http://www.brainybaby.com) or [www.vtech.com](http://www.vtech.com).



# Introduction

Thank you for purchasing the Brainy Baby® Baby Face™ learning toy.

The Brainy Baby® Baby Face™ is an electronic toy for babies 3 months and up. Press down on the plunger to watch the baby faces spin round and round. Each baby face represents a different emotion and is identified with phrases and sounds. Three Hammy buttons introduce different emotions and play fun melodies related to each emotion. Sliding moon and turning sun reward baby with fun phrases and melodies while strengthening fine motor skills.

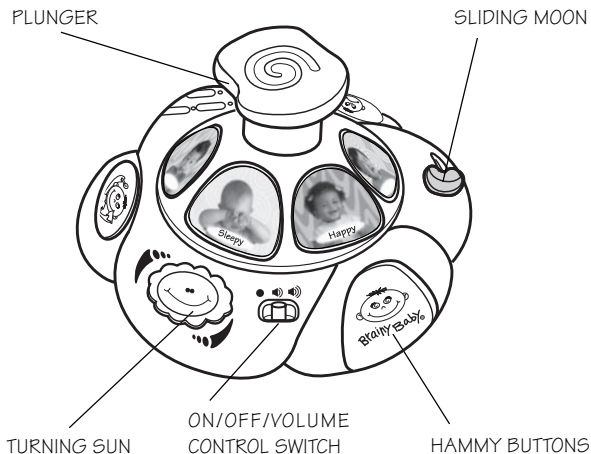

# Included in This Package

- One Brainy Baby® Baby Face™ learning toy
- One instruction manual

**WARNING:** All packing materials, such as tape, plastic sheets, wire ties and tags are not part of this toy, and should be discarded for your child's safety.

## Getting Started

### Battery Installation

1. Make sure the unit is turned off.
2. Locate the battery cover on the bottom of the unit. Use a coin or a screwdriver to loosen the screw.
3. Install 2 new "AA"(UM-3/LR6) batteries following the diagram inside the battery box. (The use of new alkaline batteries is recommended for maximum performance.)
4. Replace the battery cover and tighten the screw to secure the battery cover.

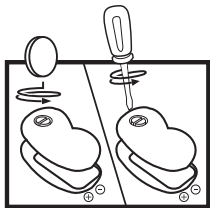

### Battery Notice



- Install batteries correctly observing the polarity (+, -) signs to avoid leakage.
- Do not mix old and new batteries.
- Do not use batteries of different types.

- Remove exhausted or new batteries from the equipment when the unit will not be used for an extended period of time.
- Do not dispose of batteries in fire.
- Do not attempt to recharge ordinary batteries.
- The supply terminals are not to be short-circuited.
- Only batteries of the same and equivalent type as recommended are to be used.

**WE DO NOT RECOMMEND THE USE OF RECHARGEABLE BATTERIES.**

## Product Features

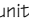
### 1. On/Off/Volume Control Switch

To turn the unit on, slide the on/off/volume control switch to the low volume (  ) or high volume (  ) position. To turn the unit off, slide the on/off/volume control switch to the off (  ) position.

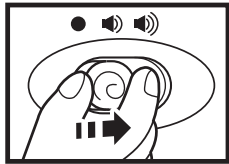

### 2. Automatic Shut-off

To preserve battery life, the Brainy Baby® Baby Face™ will automatically power-down after several seconds without input. The unit can be turned on again by pressing any button.

# Activities

1. Slide the on/off/volume control switch to turn the unit on. You will hear a giggle followed by "Hi brainy baby! How do you feel today? Can you show me your happy face?" The light will flash with the sounds.

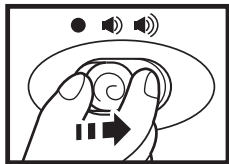

2. Press the plunger on the top of the unit. The baby faces will spin around. When the spinning stops, you will hear the emotion identified or a sound effect related to the emotion the arrow is pointing at. The light will flash with the sounds.



3. Press the Hammy buttons, slide the moon or turn the sun side to side to hear phrases, melodies and sounds. The light will flash with the sounds.

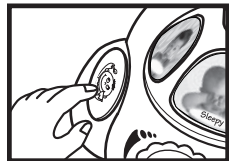

4. If there is no input after approximately five seconds, you will hear a phrase or a melody. After another five seconds if there is still no input, you will hear another phrase or melody. If there continues to be no input to the unit, it will automatically power-down.

## Melody List

1. Boom! Boom! Ain't it Great to be Crazy?
2. Are You Sleeping?
3. You Are My Sunshine
4. If You're Happy and You Know It
5. Where Has My Little Dog Gone?

## Troubleshooting

If for some reason the program/activity stops working, please follow these steps:

1. Please turn the unit off.
2. Interrupt the power supply by removing the batteries.
3. Let the unit stand for a few minutes, then replace the batteries.
4. Turn the unit on. The unit should now be ready to play again.

If the problem persists, please call our Consumer Services Department at 1-800-521-2010 in the U.S. or 1-877-352-8697 in Canada, and a service representative will be happy to help you.

For information on this product warranty, please call VTech® at 1-800-521-2010 in the U.S. or 1-877-352-8697 in Canada.

### Important Note:

Creating and developing Brainy Baby® products is accompanied by a responsibility that we at VTech® take very seriously. We make every effort to ensure the accuracy of the information, which forms the value of our products. However, errors sometimes can occur. It is important for you to know that we stand behind our products and encourage you to call our Consumer Services Department at 1-800-521-2010 in the U.S. or 1-877-352-8697 in Canada, with any problems and/or suggestions that you might have. A service representative will be happy to help you.

## Care and Maintenance

2. Keep the unit clean by wiping it with a slightly damp cloth.
3. Keep the unit out of direct sunlight and away from any direct heat source.
4. Remove the batteries when the unit is not in use for an extended period of time.
5. Do not drop the unit on hard surfaces and do not expose the unit to moisture or water.

### Note:

This equipment has been tested and found to comply with the limits for a Class B digital device, pursuant to Part 15 of the FCC Rules. These limits are designed to provide reasonable protection against harmful interference in a residential installation. This equipment generates, uses and can radiate radio



frequency energy and, if not installed and used in accordance with the instructions, may cause harmful interference to radio communications. However, there is no guarantee that interference will not occur in a particular installation. If this equipment does cause harmful interference to radio or television reception, which can be determined by turning the equipment off and on, the user is encouraged to try to correct the interference by one or more of the following measures:

- Reorient or relocate the receiving antenna
- Increase the separation between the equipment and receiver
- Connect the equipment into an outlet on a circuit different from that to which the receiver is connected
- Consult the dealer or an experienced radio/TV technician for help

THIS DEVICE COMPLIES WITH PART 15 OF THE FCC RULES. OPERATION IS SUBJECT TO THE FOLLOWING TWO CONDITIONS: (1) THIS DEVICE MAY NOT CAUSE HARMFUL INTERFERENCE, AND (2) THIS DEVICE MUST ACCEPT ANY INTERFERENCE RECEIVED, INCLUDING INTERFERENCE THAT MAY CAUSE UNDESIRABLE OPERATION.

THIS CLASS B DIGITAL APPARATUS COMPLIES WITH CANADIAN ICES-003.

CET APPAREIL NUMÉRIQUE DE LA CLASSE B EST CONFORME À LA NORME NMB-003 DU CANADA.